



Voyager II-L

Voyager II-L appeals to Hygienists and Dentists alike, with equal left- and right-handed compatibility. Voyager II-L treatment centres are extremely versatile and reliable offering incredible value to all Practices. By the nature of its ambidextrous design and outstanding ergonomics, it is both a space-saving and a very efficient working environment.

VOYAGER II-L

with unit-mounted **720-VG** operating light¹
Holder type **Air** version



VOYAGER II-L SP² – with Assistant's console



VOYAGER MC²
Air version



VOYAGER M²
Air version

¹ 'Alternative' Voyager II-L available without unit-mounted 720-VG operating light / ² Available separately
Voyager II-L operating light options, see page 35 / Standard and Ultrasoft upholstery colour ranges, see page 56

Simplicity for versatility & value :

Designed to work for Dentists and Hygienists.



Base-mounted arm provides full Operator access from 9 to 3 o'clock

VOYAGER II-L
right-handed set up

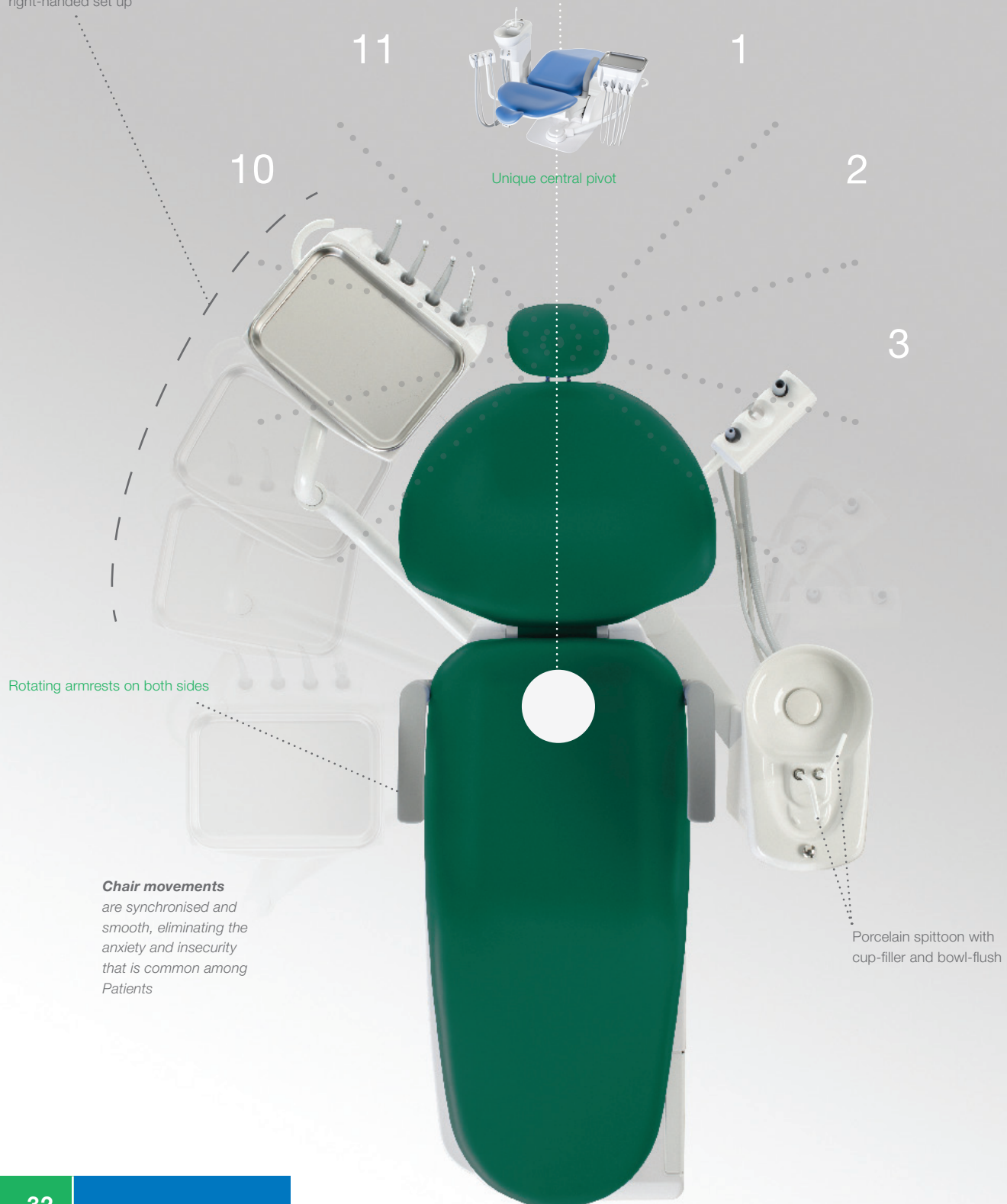

Unique central pivot

Rotating armrests on both sides

Chair movements
are synchronised and smooth, eliminating the anxiety and insecurity that is common among Patients

Porcelain spittoon with cup-filler and bowl-flush

left- & right-handed delivery :

Voyager II-L

The *central pivot design* enables the very easy changover procedure and provides 100% equality for left- and right-handed Operators. The simplicity of this elegant solution also allows the table to be positioned behind a Patient for discretion or cleaning and preparation.

Right-handed set up.
Raise chair height and release cuspidor locking pin.



Incline chair.
1-2. Swing table round to left side.

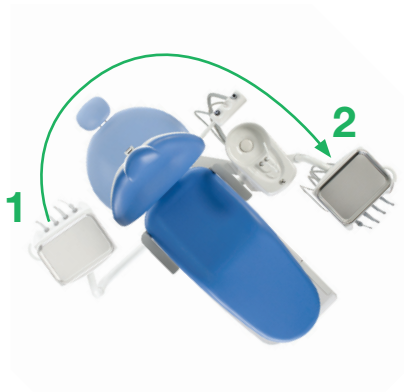

3-4. Swing cuspidor round to right side.

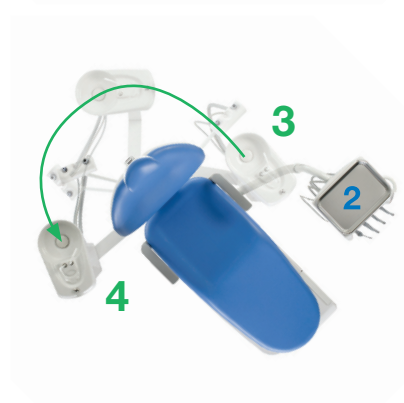

5. Secure cuspidor in position. Secure cuspidor locking lever.
2. Rotate console.

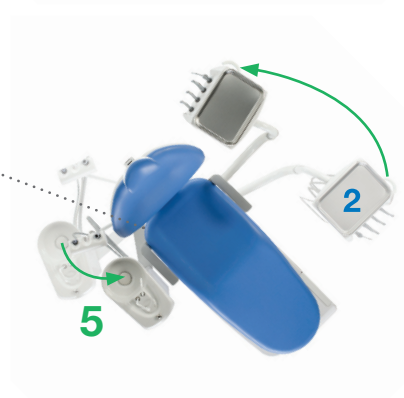

60 second changover

requires no tools, no particular strength or technique and results in identical conditions for left- and right-handed Operators.

Both the console and cuspidor easily rotate around the chair on centralised pivots below the backrest.



Left-handed set up.

Ergonomic & hygienic :

Intelligently designed for a comfortable and compact, easy-clean working environment.

VOYAGER II-L – left- and right-handed compatibility

Easy-clean porcelain spittoon

Seamless upholstery

Height-adjustable Operator's console

Rotating Assistant's console

Seamless, easy-clean upholstery offers **optimum hygiene levels**

Rotating armrests on both sides

Improved Voyager II-L chair includes lumbar support and extra padding for superior Patient comfort

Unique, centrally-mounted delivery system offers wonderful versatility on a perfectly balanced arm to ensure zero drift during operation. The treatment centre remains **compact in all positions** making comfortable operation possible in compact environments.

equipped & installed :

Voyager II-L

NDL-VG LIGHT – Unit-mounted¹



720-VG LIGHT – Unit-mounted¹



Retractable Patient mirror



Toggle switch for ON/OFF function and Composite Curing Safe Mode

Toggle switch for two light intensity settings:
Low – 18,000 Lux
High – 28,000 Lux

4200 Kelvin

Stainless steel, removable tray on non-slip silicon mat and (optional) control panel



VOYAGER MC and **VOYAGER M 'A'** versions

Operator's console and control panel² for programmable chair movements, including two preset options, Last-Position Memory, Auto-Return and manual control



Vacuum solids collector is easily accessed

Chrome flush button



VOYAGER II-L SP with **VOYAGER MC**

¹ Ceiling-mounted NDL and 700 Series lights also available, see 'Operating Lights' on pages 48-51 / ² Optional control panel